



## 19 Reddicliff Close

Plymstock, Plymouth, PL9 9QJ

£375,000



Detached house in a lovely position with beautiful gardens & views. The accommodation briefly comprises an entrance hall, open-plan lounge/dining room, conservatory, kitchen/breakfast room & ground floor 4th bedroom with an ensuite shower room. On the first floor there are 3 bedrooms, bathroom & separate wc. There are gardens to the front & rear together with a brick-paved driveway. Double-glazing & central heating. Being sold with no onward chain.





REDDICLIFF CLOSE, PLYMSTOCK, PL9 9QJ

ACCOMMODATION

Front door opening into the entrance hall.

ENTRANCE PORCH

Sliding double-glazed doors open into an entrance porch leading to the front door.

ENTRANCE HALL 7' x 5'1 (2.13m x 1.55m)

Doors providing access to the ground floor accommodation. Stairs rising to the first floor. Consumer unit.

LOUNGE/DINING ROOM 25'3 x 12'4 (7.70m x 3.76m)

A spacious open-plan reception room with a window with fitted blind to the front elevation. Chimney breast with an inset glass-fronted electric fire. Ample space for seating and dining. Doorway opening into the kitchen/breakfast room. Sliding double-glazed doors opening into the conservatory.

KITCHEN/BREAKFAST ROOM 12'4 x 10'10 (3.76m x 3.30m)

Range of base and wall-mounted cabinets with natural pine fascias, work surfaces and tiled splash-backs. Ample space for breakfast table and chairs. Stainless-steel one-&-a-half bowl single drainer sink unit. Built-in Bosch dual oven and grill. Separate Rangemaster 5-burner gas hob with a cooker hood above. Space for washing machine and tumble dryer beneath the work surface. Space for further free-standing appliances, such as a fridge-freezer. Recessed pantry-style cupboard with shelving. Inset ceiling spotlights. Over-head skylight. Window to the rear elevation. Glazed door overlooking the garden and leading to outside.

CONSERVATORY 14'6 x 7'8 (4.42m x 2.34m)

Glazed to 3 sides beneath a glazed roof. Fitted blinds. Sliding doors leading to outside. Lovely views over the garden towards woodland.

BEDROOM FOUR 11'10 x 8'8 (3.61m x 2.64m)

Window with fitted blind to the front elevation. Loft hatch. Doorway opening into the ensuite shower room.

ENSUITE SHOWER ROOM 8'5 x 3'11 (2.57m x 1.19m)

Comprising a double-sized enclosed tiled shower with a built-in shower system, basin with a cupboard beneath and wc. Electric heated towel rail. Wall-mounted gas boiler. Partly-tiled walls. Inset ceiling spotlights.

FIRST FLOOR LANDING

Providing access to the first floor accommodation. Loft hatch. Recessed cupboard with slatted shelving.

BEDROOM ONE 14'5 to wardrobe rear x 8'11 (4.39m to wardrobe rear x 2.72m)

Window with a fitted blind to the front elevation with lovely views. Built-in wardrobes with sliding doors.

BEDROOM TWO 10'7 x 8' (3.23m x 2.44m)

Window with a fitted blind to the rear elevation with lovely views over the garden.

BEDROOM THREE 8'6 x 6'6 (2.59m x 1.98m)

Window with fitted blind to the front elevation with lovely views.

BATHROOM 5'5 x 4'7 (1.65m x 1.40m)

Comprising a bath with a mixer tap shower over and pedestal basin. Chrome towel rail/radiator. Fully-tiled walls.

SEPARATE WC

Fitted with a wc. Cupboard with shelving. Fully-tiled walls. Obscured window to the side elevation.

OUTSIDE

To the front is a brick-paved driveway providing off-road parking. Beside the drive there is an area of garden laid to lawn. Pathways lead around both side elevations accessing the rear garden. The rear garden extends in a southerly direction and backs onto woodland. The garden is laid to lawn together with beautifully-kept shrub and flower beds. There are 3 plastic sheds and 1 timber shed and adjacent to the property is a paved patio area.

COUNCIL TAX

Plymouth City Council  
Council tax band D

Area Map



Floor Plans

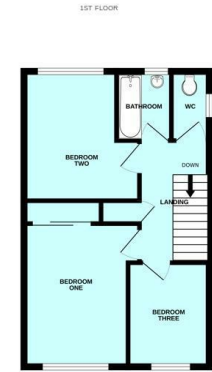

Energy Efficiency Graph

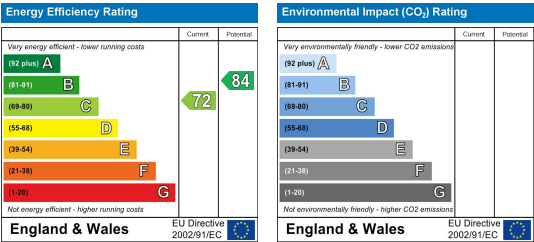

These particulars, whilst believed to be accurate are set out as a general outline only for guidance and do not constitute any part of an offer or contract. Intending purchasers should not rely on them as statements of representation of fact, but must satisfy themselves by inspection or otherwise as to their accuracy. No person in this firms employment has the authority to make or give any representation or warranty in respect of the property.